

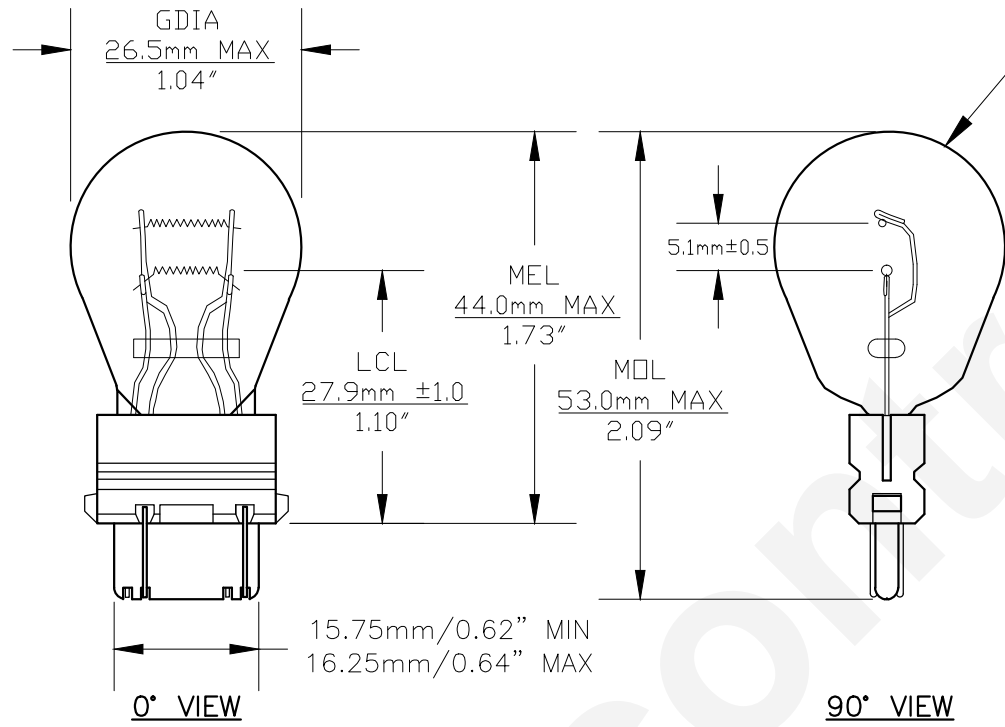

| PART NO. | BASE TYPE | DESIGN VOLTS | DESIGN AMPS | MSCD | FILAMENT TYPE | AVERAGE LIFE HOURS |
|----------|-----------------------------|----------------|--------------------|-----------------|---------------|--------------------|
| 3157 | D.F. Plastic Wedge W2.5X16q | 12.8V 14.0V | 2.10±5% 0.59±8% | 32±10% 3±12% | C-6 C-6 | 1200 5000 |

| REVISIONS | | | |
|-----------|------------------------------------|------------|----------|
| REV # | DESCRIPTION | DATE | APPROVED |
| 1 | ISSUED | 04/09/2001 | E.S. |
| 2 | UPDATED DIMENSIONS | 12/05/2005 | D.C. |
| 3 | ADDITIONAL VIEW | 04/09/2007 | D.C. |
| 4 | ADDED FILAMENT DISTANCE DIMENSIONS | 10/04/2018 | R.M. |



S-8 BULB SHAPE
Clear Glass

Plastic Base, Color: BLACK

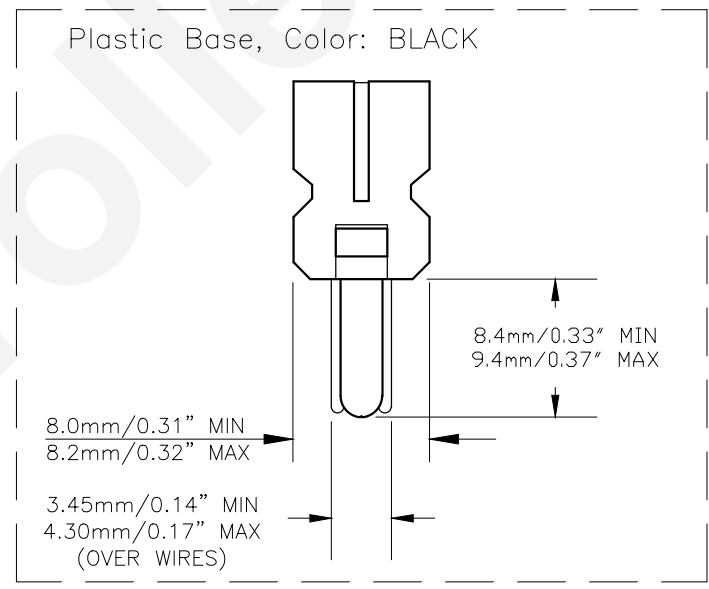

Note: Made according to SAE specifications

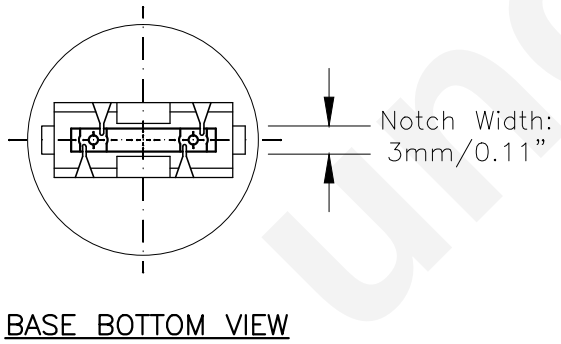

| | | | |
|---|-----------------|--|----------------------|
| UNLESS OTHERWISE SPECIFIED: DIMENSIONS ARE IN INCHES TOLERANCES | | CEC INDUSTRIES LTD | |
| DECIMALS | ANGULAR | 599 BOND STREET LINCOLNSHIRE, IL 60069 | |
| .XX ± .05 | ± 0.5° | TITLE LIGHT BULB NO. 3157 (P27-7W) | |
| .XXX ± .010 | | SIZE A | REV 4 |
| FRACTIONAL | ±1/64 | FSCM NO. | DWG NO. 3157 |
| DRAWN ELIZABETH SONANES | DATE 04/09/2001 | SCALE | SHEET 1 OF 1 |
| CHECKED | | PLOT SCALE | DRAWING NOT TO SCALE |
| DESIGN | | FILE 3157.pdf | |
| MATERIAL | | | |